



KITAMAK
OTOMOTİV YEDEK PARÇA

KATALOG
2024

[WWW.KITATECH.COM](http://www.kitatech.com)

KITAMAK

TECH

OTOMOTİV YEDEK PARÇA



Bu katalogta kullanılan araç ve orjinal parça imalatçı referans numaraları sadece bilgi ve karşılaştırma amacı ile kullanılmıştır. Ürünlerimizin tamamı orjinal ekipman değildir. Ancak orjinal ürünler yerine kullanılabilir.

Bu katalog KITAMAK SAN. ve TİC. tarafından hazırlanmıştır.

Katalogumuzda yer alan görsellerin firmamızın yazılı izni olmadan kısmen yada tamamen kopyalanması veya dağıtılması yasaktır.

The reference numbers which are used in this catalogue are for information and comparison purposes only. This catalogue is property of KITAMAK SAN. ve TİC. It is strictly forbidden to copy or distribute the visuals that are used in this catalogue without our written permission.

WWW.KITATECH.COM

INDEX

Fiat Kapı Gergileri / Fiat Door Check Straps 6 - 25



HAKKIMIZDA

Bir aile firması olan Kitamak Sanayi Ve Ticaret 2006 yılında kurulmuştur.

Çeşitli sektörler için kalıp imalatı yapan Kitamak 2011 yılından itibaren kapı gergileri üzerine yoğunlaşmıştır.

Stoklu çalışma sistemi , gelen siparişlere sunduğu hızlı çözümler ile siz değerli müşterilerine güven vermektedir.

Firmamız Kitatech markası ile birçok marka aracın kapı gergilerinin üretimini yapmaktadır.

Firmamız , üretim ve depo olmak üzere 2 ayrı binamız ile yaklaşık 1000 m² de hız kesmeden devam etmektedir.

Yurt içinde bir çok firma ile çalıştığı gibi 2014 yılından itibaren birçok ülkeye ihracat yapmaktadır.

Kaliteli ve sistemli üretim anlayışını benimseyen Kitamak her geçen gün arttırdığı ürün çeşidi, yenilikçi vizyonu ve müşteri odaklı hizmet anlayışı ile çalışmalarını sürdürmektedir.

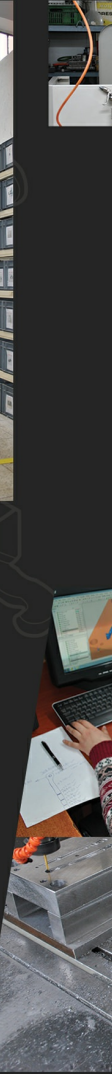



ABOUT US

Kitamak was founded in 2006, as a family company.

Kitamak, which has been producing molds for various sectors, has focused on door check straps since 2011.

With its prompt response to demands, our Make To Stock System gives confidence to our valuable customers.

Our company manufactures door tensions for many vehicles of different brands with the brand Kitatech.

Our company continues without slowing down an area of approximately 1000 m² with 2 separate buildings, production and warehouse.

As we work with many companies in Turkey, we are exporting to many countries since 2014.

Adopting a quality and systematic production approach, Kitamak continues to work with its product variety, innovative vision and customer-oriented service understanding.



**MARKA TESCİL BELGEMİZ /
TRADEMARK REGISTRATION CERTIFICATE**



T.C.
TÜRK PATENT ENSTİTÜSÜ

MARKA TESCİL BELGESİ

Marka No : 2012 53251 - Ticaret



Marka Sahibi : SABRİ HATİPOĞLU (T.C. Kimlik No: 32926212816)
TÜRKİYE CUMHURİYETİ
KÜÇÜK BALIKLI MAH. KÖŞK CAD. NO : 65
OSMANGAZİ BURSA
Emtiası : 06
İlişiktir.

Markaların Korunması Hakkında 556 Sayılı Kanun Hükmünde
Kararnameye göre 11/06/2012 tarihinden itibaren ON YIL müddetle
06/08/2013 tarihinde tescil edilmiştir.

Elif B. AKIN
Enstitü Başkanı a.
Markalar Dairesi Başkanı

TÜRK PATENT [] ENSTİTÜSÜ

MARKA TESCİL BELGEMİZ / TRADEMARK REGISTRATION CERTIFICATE



Registered / Registrado 20/11/2021

No 018489571

EUROPEAN UNION INTELLECTUAL PROPERTY OFFICE CERTIFICATE OF REGISTRATION

This Certificate of Registration is hereby issued for the European Union trade mark identified below. The corresponding entries have been recorded in the Register of European Union trade marks.

OFICINA DE PROPIEDAD INTELECTUAL DE LA UNIÓN EUROPEA CERTIFICADO DE REGISTRO

Se expide el presente Certificado de Registro para la Marca de la Unión Europea que se identifica a continuación. Las menciones y las informaciones relativas a tal marca han sido inscritas en el Registro de Marcas de la Unión Europea.

The Executive Director / El Director
Ejecutivo

Christian Archambeau



www.euipo.europa.eu



FIAT



1601



Oe Ref: 46424567
DOOR CHECK STRAP
TEMPRA (1989 - 1996)
TIPO (1987 - 1996)
FRONT RIGHT , FRONT LEFT

1602



Oe Ref: 46424566
DOOR CHECK STRAP
TEMPRA (1989 - 1996) REAR RIGHT , REAR LEFT
TIPO (1987 - 1996) FRONT RIGHT , FRONT LEFT

1603



Oe Ref: 1354694080
95509356
9035.AP
DOOR CHECK STRAP
QUBO (2008 - ..)
DOBLO III (2010 - ..)
FIORINO (2007 - ..)
FRONT RIGHT , FRONT LEFT

1604



Oe Ref: 51772768
DOOR CHECK STRAP
DOBLO I (2001 - 2009)
FRONT RIGHT , FRONT LEFT

1605



Oe Ref: 46844990
46844992
46539531
51803054
51803055
DOOR CHECK STRAP
SIENA (1996 - 2014) FRONT RIGHT , FRONT LEFT
PALIO (1996 - 2017) FRONT RIGHT , FRONT LEFT
ALBEA (1996 - 2015) FRONT RIGHT , FRONT LEFT
STRADA

1606



Oe Ref: 46845412
51803056
DOOR CHECK STRAP
ALBEA (1996 - 2015)
PALIO (1996 - 2017)
SIENA (1996 - 2014)
REAR RIGHT , REAR LEFT

1607



Oe Ref: 46782841
DOOR CHECK STRAP
BRAVA (1995 - 2002)
BRAVO (1995 - 2001)
MAREA (1996 - 2002)
FRONT RIGHT , FRONT LEFT

1608



Oe Ref: 465638541
DOOR CHECK STRAP
BRAVA (1995 - 2002)
BRAVO (1995 - 2001)
MAREA (1996 - 2002)
REAR RIGHT , REAR LEFT

1609



Oe Ref: 1328196080
9181.G3

DOOR CHECK STRAP

DUCATO II (1994 -2006)
FRONT RIGHT , FRONT LEFT

1610



Oe Ref: 1358220080
1394172080
9181.N9
1388430080
1613353680

DOOR CHECK STRAP

DUCATO III (2006 - ..)
FRONT RIGHT , FRONT LEFT

1611



Oe Ref: 51799767
51818431

DOOR CHECK STRAP

PUNTO
GRANDE PUNTO
LINEA
FRONT RIGHT , FRONT LEFT

1612



Oe Ref: 46844990

DOOR CHECK STRAP

SIENA (CİVATALI & BOLTED)
PALIO (CİVATALI & BOLTED)
ALBEA (CİVATALI & BOLTED)
FRONT RIGHT , FRONT LEFT

1613



Oe Ref: 46845412

DOOR CHECK STRAP

SIENA (CİVATALI & BOLTED)
PALIO (CİVATALI & BOLTED)
ALBEA (CİVATALI & BOLTED)
REAR RIGHT , REAR LEFT

1614



Oe Ref: 51772768

DOOR CHECK STRAP

DOBLO I (CİVATALI & BOLTED)
FRONT RIGHT , FRONT LEFT

1626



Oe Ref: 1314825080
9181.79

DOOR CHECK STRAP

DUCATO I (1994 -2002)
JUMPER I (1994 - 2002)
BOXER I (1994 - 2002)
FRONT RIGHT , FRONT LEFT

1628



Oe Ref: 51799769
51765584
51753656

DOOR CHECK STRAP

GRANDE PUNTO
LINEA
REAR RIGHT , REAR LEFT

1630



Oe Ref: 51799708
DOOR CHECK STRAP
DOBLO II (2005 - 2010)
FRONT RIGHT , FRONT LEFT

1631



Oe Ref: 51754186
DOOR CHECK STRAP
PUNTO 188 (1999 - 2012)
FRONT RIGHT , FRONT LEFT

1632



Oe Ref: 51782989
DOOR CHECK STRAP
500 (2008 - 2017)
500 C (2009 - 2015)
595C (2009 - 2017)
ABARTH 500 (2008 - 2017)
FRONT RIGHT , FRONT LEFT

1633



Oe Ref: 51983934
DOOR CHECK STRAP
EGEA (2015 - ..)
TIPO (2015 - ..)
FRONT RIGHT , FRONT LEFT

1634



Oe Ref: 51983608
DOOR CHECK STRAP
EGEA (2015 - ..)
TIPO (2015 - ..)
REAR RIGHT , REAR LEFT

1635



Oe Ref: 51760102
46784978
46835940
DOOR CHECK STRAP
STILO (2001 - 2008)
FRONT RIGHT , FRONT LEFT

1636



Oe Ref: 46790818
TRUNK DOOR HINGE
DOBLO I (2001 - 2006)
BAGAJ SAĞ , BAGAJ SOL

1637



Oe Ref: 51801197
TRUNK DOOR HINGE
DOBLO II (2005 - 2009)
BAGAJ SAĞ , BAGAJ SOL

1638

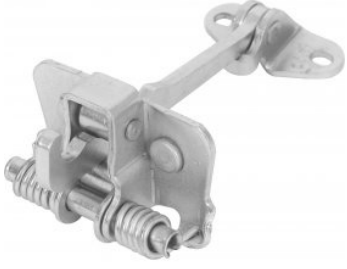

Oe Ref: 1462455080
9181 90

DOOR CHECK STRAP

SCUDO I (1996 - 2006)
FRONT RIGHT , FRONT LEFT

1639



Oe Ref: 1440204880
9181 K9

DOOR CHECK STRAP

SCUDO II (2007 - ..)
FRONT RIGHT , FRONT LEFT

1640



Oe Ref: 51883508

DOOR CHECK STRAP

500 L (2012 - 2018)
FRONT RIGHT , FRONT LEFT

1641



Oe Ref: 1358221080
1384813080
8731.R0
1613353780

TRUNK DOOR HINGE

DUCATO III (2006 - ..)
SAĞ BAGAJ

1642



Oe Ref: 1358222080
1384814080
8731.R1
1613353880

TRUNK DOOR HINGE

DUCATO III (2006 - ..)
SOL BAGAJ

1643



Oe Ref: 51779914
46826480

DOOR CHECK STRAP

PANDA II (2003 - 2009)
FRONT RIGHT , FRONT LEFT

1644



Oe Ref: 51883509

DOOR CHECK STRAP

500 L (2012 - 2018)
REAR RIGHT , REAR LEFT

1645



Oe Ref: 51961550
51961551
51860292

DOOR CHECK STRAP

GRANDE PUNTO (2009-2013)
PUNTO EVO (2009-2011)
PUNTO (2012-2017)
FRONT RIGHT , FRONT LEFT

1646



Oe Ref: 51961552
51860295
DOOR CHECK STRAP
PUNTO (2012-2017)
GRANDE PUNTO (2009-2013)
PUNTO EVO (2009-2011)
REAR RIGHT , REAR LEFT

1647



Oe Ref: 51751732
DOOR CHECK STRAP
BRAVO II (2007 - 2014)
FRONT RIGHT , FRONT LEFT

1648



Oe Ref: 51805582
DOOR CHECK STRAP
BRAVO II (2007 - 2014)
REAR RIGHT , REAR LEFT

1649



Oe Ref: 51939940
DOOR CHECK STRAP
500 X (2014 - ..)
FRONT RIGHT , FRONT LEFT

1650



Oe Ref: 51939944
DOOR CHECK STRAP
500 X (2014 - ..)
REAR RIGHT , REAR LEFT

1651



Oe Ref: 46826530
DOOR CHECK STRAP
PANDA II (2003 - 2009)
REAR RIGHT , REAR LEFT

1652



Oe Ref: 51795854
DOOR CHECK STRAP
IDEA (2003 - 2012)
FRONT RIGHT , FRONT LEFT

1653



Oe Ref: 51782471
51798427
DOOR CHECK STRAP
IDEA (2003 - 2012)
REAR RIGHT , REAR LEFT

1655



Oe Ref: 51790088
51884302
DOOR CHECK STRAP
PUNTO 188 (1999 -2012)
REAR RIGHT , REAR LEFT

1663



Oe Ref: 1388875080
1366303080
1355023080
9035AQ
1617418980
TRUNK DOOR HINGE
FIORINO (2007 - ..) SAĞ BAGAJ
FIORINO (2007 - ..) SOL BAGAJ
QUBO (2008 - ..) SAĞ BAGAJ
QUBO (2008 - ..) SOL BAGAJ

1664



Oe Ref: 51879452
51811554
51995866
52055133
TRUNK DOOR HINGE
DOBLO III (2010 - ..) SOL BAGAJ
DOBLO III (2010 - ..) SAĞ BAGAJ

1665



Oe Ref: 51754187
0051754187
46836440
0046836440
DOOR CHECK STRAP
PUNTO 188 3 KAPI & 3 DOOR (1999 - 2012)
FRONT RIGHT , FRONT LEFT

1666



Oe Ref: 46553843
46513345
DOOR CHECK STRAP
SEICENTO (1998 - 2010)
FRONT RIGHT , FRONT LEFT

1667



Oe Ref: 51754188
46836441
DOOR CHECK STRAP
PUNTO 188 (1999 -2012)
REAR RIGHT , REAR LEFT

1669



Oe Ref: 52022102
DOOR CHECK STRAP
PANDA IV (2012-)
FRONT RIGHT , FRONT LEFT

1670



Oe Ref: 52022104
51930307
DOOR CHECK STRAP
PANDA IV (2012-)
REAR RIGHT , REAR LEFT

1794



Oe Ref: 804300242R
93867645
4407217
6000617401

DOOR CHECK STRAP
TALENTO (2016 - ..)
FRONT RIGHT , FRONT LEFT

1971



Oe Ref: 9181G9
1440205580
1484407080

DOOR CHECK STRAP
ULYSSE II (2002 - 2011)
FRONT RIGHT , FRONT LEFT

NOT / NOTE



NOT / NOTE



The letters 'KIT' are rendered in a large, bold, sans-serif font. Each letter is filled with a red-tinted image of various automotive mechanical parts, such as pistons, valves, and belts, creating a textured, industrial appearance.The letters 'TECH' are rendered in a large, bold, sans-serif font. Each letter is filled with a black and white image of various automotive mechanical parts, such as pistons, valves, and belts, creating a textured, industrial appearance.

AUTOMOTIVE SPARE PARTS

WWW.KITATECH.COM



KITAMAK
AUTOMOTIVE SPARE PARTS

Otomotiv Yedek Parça İmalatı San. ve Tic.
Küçükbalıklı Mh. 2.Köşk Cd.
No:65 16250
Osmangazi/BURSA/TÜRKİYE
Tel:+90 224 216 14 60
Faks:+90 224 215 56 37

satinalma@kitatech.com
sales@kitatech.com

WWW.KITATECH.COM